

RECESSED MOUNTED CEILING LUMINAIRE
FOR ACCOMMODATION AND PUBLIC AREAS

Design	According to rules of maritime classification societies and relevant standards
Housing	Galvanized steel, powder coated white (RAL9016)
Diffuser	Clear polycarbonate with ice crystal structure
Mounting	Mounting set for ceilings 23–55 mm
Cable entry	2 inlets for cables max. Ø 13 mm
Protection class	IP20 / IP44 in conjunction with ceiling, IP20 with louver
Weight	4.0 kg
Light source	Linear LP LED modules
Wattage	Max. 20 W
CCT (color)	3,000 K or 4,000 K
Luminous flux	1,500 lm
CRI	≥ 80
Voltage	220–240 V AC
Frequency	50–60 Hz

PART NO.

DE29S

5111009110-xxx

SPARE PARTS

PART NO.

Icecrystal cover (DE29S)

7931000900

EXTRAS

- > 120 V AC execution
- > 24 V DC execution
- > Dimmable
- > Emergency battery back-up
- > Alternative housing colors
- > Different louvers and diffusers
- > Different mounting sets

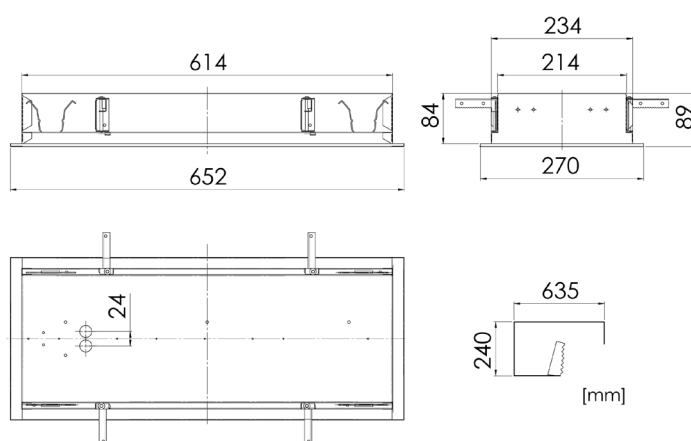

Contact: +971507924960
Email: sales@industrytechstore.com

INDUSTRY
TECH STORE



Find our complete
digital catalogue here:

