



Visual & Acoustic Signals - Industrial ELECTRONIC SOUNDER & BEACON COMBINED

Electronic Sounder & Beacon Combined Klaxon > AE L/X 105, 110, 120

Product overview

The AE L/X 105, 110 & 120 'NEXUS' range of electronic sounder/beacons are suitable for a wide range of fire and Industrial signalling applications where a high degree of signalling versatility is required in the environment.

The units offer a three stage alarm with sixty four separate tone options that are automatically synchronised on multi unit installations, selectable inside the unit via a six way dip switch.

The range has been designed to allow a 'first fix' wiring solution. Connections are made in the base during initial wiring phase which results in faster and more reliable installation. The 'sounder head' is then fixed into position using four captive, quarter turn fasteners, giving accurate seal compression for weatherproofing. There are five cable entry options allowing for termination inside the enclosure.

This range offers a choice of either LED or Xenon visual warning. LED being the more power efficient option, Xenon giving a more industrial warning signal.

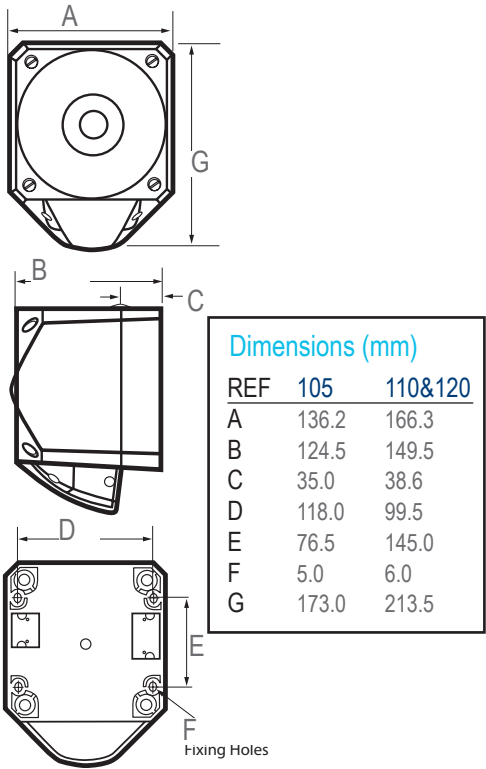

AE L/X 105, 110, 120 Series > Ordering Information

Code No:	Voltage:	Light Source:	Current:	dB at 1m:
AEL105-02MF	10-60v Dc ---	LED	26-58 mA •	100-113
AEX105-02MF	10-60v Dc ---	Xenon	358-390 mA •	100-113
AEX105-04MF	115/230v Ac ~	Xenon	110 mA	100-113
AEL110-02MF	10-60v Dc ---	LED	28-68 mA •	104-116
AEX110-02MF	10-60v Dc ---	Xenon	360-400 mA •	104-116
AEX110-04MF	115/230v Ac ~	Xenon	110 mA	104-116
AEL120-02MF	10-60v Dc ---	LED	138-568 mA •	110-120
AEX120-02MF	10-60v Dc ---	Xenon	470-900 mA •	110-120
AEX120-04MF	115/230v Ac ~	Xenon	110 mA	110-120

- Subject to voltage, tone selection and LED beacon set to flash mode.

ADD THE FOLLOWING LENS CODES TO THE PRODUCT WHEN ORDERING

01

02

03

04

05

Note: 105 Fixing detail is shown

Features

- Continuously rated
- Suitable for surface, conduit box or wall mounting
- Wide operating voltage
- Audible & visual warning signal
- Conforms to EN54-3 Type B for Fire Alarm use (Dc Only)
- Vds & NF approved versions available upon special request only
- Dustproof and Weatherproof

Material

Flame Retardant ABS

Kg 0.8, 1.2, 2.0

50/60 Hz

°C -25+55 Ac
-25+70 Dc

IP 66

FPM 60

INDUSTRIAL

APPROVALS and
CONFORMITIES



MARINE

FIRE