

Emergency luminaire With LED

GRP

L409/4328-5101-162-1110-11-850011 Art. No. 278302



- Long-lasting LED version of the EXLUX family in an industrial design
- Robust, durable enclosure with central lock for use as humidor lighting
- Integrated, automatically started test function for the integrated battery
- Up to 3 hours battery runtime with a luminous flux of 1000 lm in emergency operation
- Available with warm white, neutral white and cold white colour temperatures

MY R. STAHL L409A

The EXLUX L409/4 light fitting completes the LED linear luminaire range. The industrial design of the emergency luminaires offers all the advantages of the robust enclosure technology and long-lasting LED technology for which the EXLUX range is known. This automatically starts all test functions set out as mandatory in standards and the ergonomic light fitting device provides clear signals. The entire range of installation material for the EXLUX family is also available.

Technical Data

Explosion Protection

Ex version	Industrial design
------------	-------------------

Electrical Data

Rated operational voltage AC	110 ... 240 V
Battery version	NiCd battery, gas-tight
Battery operating voltage	6 V
Battery capacity	7 Ah
Self-test function	With (standard)
Frequency range	50 – 60 Hz

Lighting Data

Number of lamps	1
Lamp wattage	25 W
Lamp	LED
Light colour	5000 K – neutral white
Light distribution	120°x120° with diffusing glass
Luminaire efficacy	116 lm/W
Luminous flux	2910 lm
Operating time	1.5h emergency lighting operation
Emergency light output	65% – 1.5 h
Colour rendering	≥ 80
Colour temperature	5000 K

Ambient Conditions

Ambient temperature	-30 °C ... +50 °C Note: Through wiring Max. 3x16 A -30 °C ... +55 °C Note: Through wiring 2 Max. 3x10 A
---------------------	--

Mechanical Data

Version	Standard
IP degree of protection (IEC 60598)	IP66/IP67

Lighting

Emergency luminaire With LED

GRP

L409/4328-5101-162-1110-11-850011 Art. No. 278302

STAHL

Mechanical Data

Enclosure material	Polyester resin, Glass fibre reinforced
Enclosure colour	Light grey (RAL 7035)
Diffuser	With diffuser
Sealing material	Silicone
Silicone-free content	Contains silicone
Translucent cover material	Polycarbonate
Installed terminal strip	PE + N + L1 + L2 + L3 + L'
Max. solid connection terminals	6 mm ²
Max. finely stranded connection terminals	4 mm ²
Type of connection cable	Finely stranded Solid
Size	2
Width	183.5 mm
Height	125 mm
Length	857 mm
Impact strength (IEC 62262)	IK10
Weight	5.4 kg
Weight	11.9 lb
Disconnection of the luminaire	Only battery
Components	
Threaded plate	2x plastic
Ballast	LED NLE 80W 110-240V/7Ah/1.5h/
Through wiring	With 6 conductors 2.5 mm ²
Drilled holes	3 x M25
Cable glands and entries	2 x M25 Ø 7 ... 17 mm
Material cable gland	Polyamide, black
Stopping plugs	2 x M25 x 1.5
Stopping plug material	Polyamide, black
Accessories	Provided

Dimensional Drawings (All Dimensions in mm [inches]) – Subject to Alterations

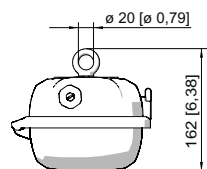

Ring bolt fitted in insert nut of the luminaire

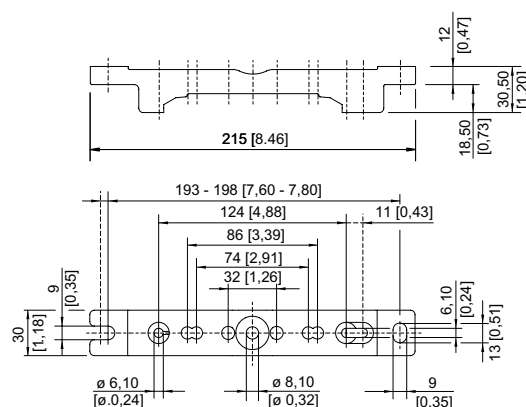

Mounting rail

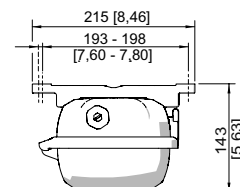

Mounting rail

Lighting

Emergency luminaire With LED

GRP

L409/4328-5101-162-1110-11-850011 Art. No. 278302

STAHL

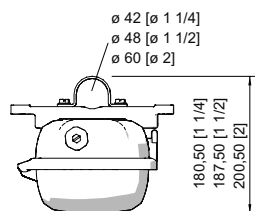

Pipe clamp fitted in mounting rail

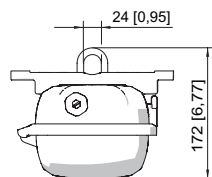

Mounting bracket fitted in mounting rail

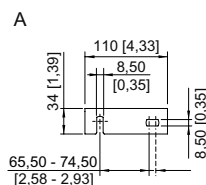
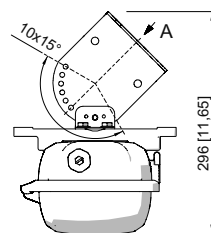

Wall mounting bracket fitted in mounting rail

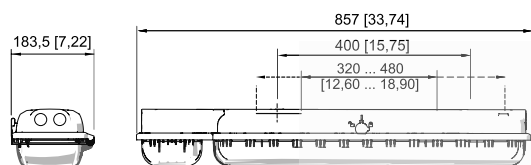

Size 2

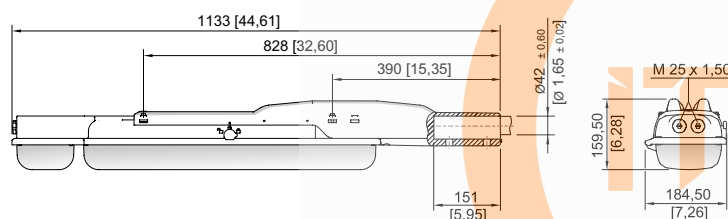

Size 2

Accessories

Box spanner

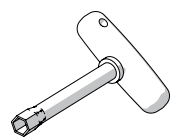

M8 / A/F 13;
For actuating the central lock

Art. No.

222430

Breather

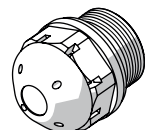

Thread: M25 x 1.5 (20 pieces); without jam nut

Art. No.

285780

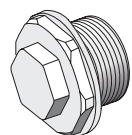

Thread: M25 x 1.5 (1 piece); for installation in light fittings; made from stainless steel; without jam nut

296608

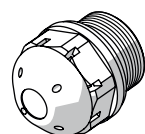

M25 x 1.5 in order to avoid condensate formation

115738

Lighting

Emergency luminaire With LED

GRP

L409/4328-5101-162-1110-11-850011 Art. No. 278302

STAHL

Ceiling and wall mounting bracket

Art. No.

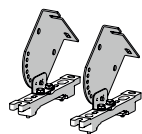

mounted on a mounting rail for a variable mounting distance; Material: stainless steel; Lamp can be swiveled in steps of 15°; 1 pair

222827

Holder for translucent cover

Art. No.



The fall prevention system for the light fitting cover prevents the light fitting cover from falling accidentally when the light fitting is opened.

226791

Mounting bracket

Art. No.

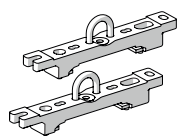

mounting clamp mounted on a mounting rail for a variable mounting distance; 1 pair

222456

Mounting rail

Art. No.

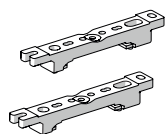

for a variable mounting distance; 1 pair

222826

Pipe clamp

Art. No.

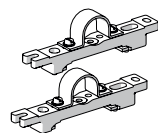

R 1 1/2"; with mounting rail for a variable mounting distance; material: stainless steel; 1 pair

222459

R 1 1/4"; with mounting rail for a variable mounting distance; Material: stainless steel; 1 pair

222458

R 2"; with mounting rail for a variable mounting distance; Material: stainless steel; 1 pair

222460

Pole mounting sleeve

Art. No.



for the subsequent mounting on lights size 2 and size 4, completely with assembly parts (for pipe diameter 42 mm)

227512

Protection against accidental contact

Art. No.

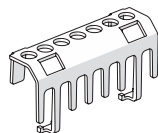

The protection against accidental contact prevents maintenance technicians and electrical installers from accidentally touching conductive parts. The degree of protection is increased to IP20 when the protection against accidental contact is used.

283153

Spare Parts

Cover

Art. No.

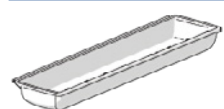

for luminaire size 2

222427

Lighting

Emergency luminaire With LED

GRP

L409/4328-5101-162-1110-11-850011 Art. No. 278302

STAHL

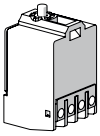
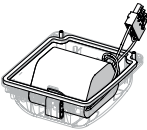
Contact element		Art. No.
	8080/1-3-L 2 NC contact element	132527
Battery set		Art. No.
	Battery cover with built-in battery. Gas-tight NiCd battery; 7 Ah / 6 V	223532

We reserve the right to make alterations to the technical data, dimensions, weights, designs and products available without notice. The illustrations cannot be considered binding.

